



LAMTEC Meß- und Regeltechnik
für Feuerungen GmbH & Co. KG
Wiesenstraße 6
D-69190 Walldorf (Baden)

phone +49 (0) 62 27 - 60 52 0
fax number +49 (0) 62 27 - 60 52 57
www.lamtec.de
info@lamtec.de

Gestaltung: www.netz-studio.de Foto Titel © istockphoto

SENSORS AND SYSTEMS FOR COMBUSTION ENGINEERING



Development - Production - Sales - Service



Sales Partners Worldwide.

Combustion management
Process measuring and control technology for combustion



Combustion management Process measuring and control technology for combustion

BurnerTronic BT300



- » Modular burner control
- » 3/4 channel fuel/air ratio control
- » Graphical menu navigation
- » Actuator up to 9 Nm
- » Firing-rate, RPM, CO/O₂ control optional

ETAMATIC



- » Compact burner control
- » 4 channel fuel/air ratio control
- » Actuator up to 40 Nm
- » RPM control (ETAMATIC S)
- » CO/O₂ control optional

NEMS



- » New value/first value and process indicator system
- » Local system, 16 inputs/module
- » 24 V DC or 230 V AC indicator input
- » Resolution of safety interlock chains
- » Coupleable with ETAMATIC / FMS

Stagnation pressure grid



- » Volumetric flow measurement of gaseous mediums
- » Combustion air up to 400 °C
- » Low head loss
- » Construction type perpendicular or circular
- » Short inlet/outlet paths

ETAMATIC OEM



- » Functionality as ETAMATIC
- » Mounting on burner side
- » Separate operating unit
- » Programming unit with start-up assistant

FMS



- » Universal, multifunctional burner control
- » 4/5 channel fuel/air ratio control
- » Up to 8 curve sets optional
- » Simultaneous combustion of 2 fuels optional
- » Firing-rate, CO/O₂ control optional

Combustion engineering - a one-stop shop

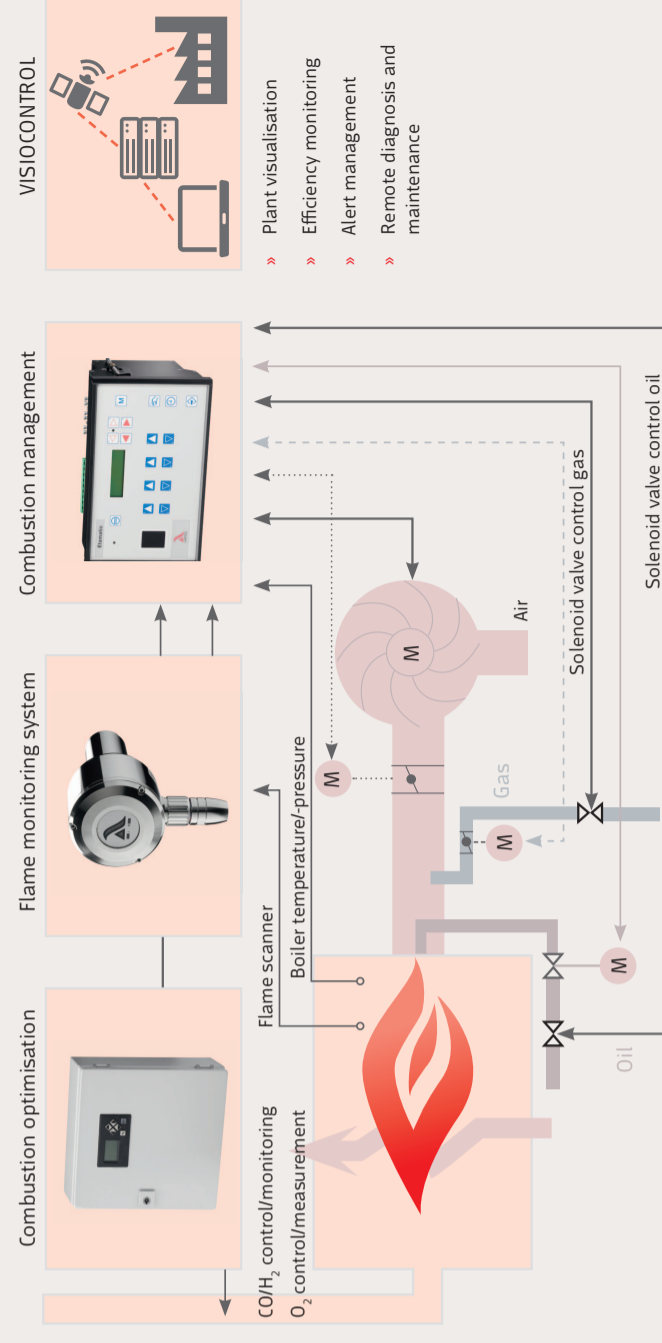

Integrated LAMTEC CO/O₂ control